



primus®

GET AHEAD IN FACILITY MANAGEMENT LAUNDRY



TESTED AND CERTIFIED
BY EXPERTS FOR
DISINFECTION AT 40°C¹

¹99,9999 % reduction of *Escherichia coli* K12 NCTC 10538, *Staphylococcus aureus* ATCC 6538, *Salmonella enterica* ATCC 13076, *Candida albicans* ATCC 10231, *Aspergillus brasiliensis* ATCC 16404 in the mop washing program „Mop washing program for main wash temperature 40° C“ with „Eltra 40 extra“ laundry detergent and a load size of 7.5 kg - investigation MB 1880/19 dated April 16, 2020 conducted by wfk-Institut für Angewandte Forschung GmbH commissioned by Alliance Laundry CE s.r.o..



CHOOSING PRIMUS IS THE BEST LAUNDRY DECISION

You don't buy commercial laundry equipment every day. That's why you need absolute certainty to make the right choice.

It often makes solid business sense to go with the global leader when choosing a partner. In commercial laundry, the world leader is Alliance Laundry Systems.



PRIMUS offers a wider range of machines. Tell us your needs. We'll help you select the right laundry solution that will meet them.



PRIMUS has developed a full range of extensively tested machines to provide you long lasting washing performance.



PRIMUS is exclusively available from our experienced and knowledgeable distributors. They are at your service to help you with whatever is necessary to ensure optimum laundry uptime.



Backed by Alliance Laundry Systems, the world leader in commercial laundry, Alliance Laundry Systems Financial Services, provides specific solutions for the commercial laundry industry.



LAUNDRY PEACE-OF-MIND FROM THE WORLD EXPERT

As part of Alliance Laundry Systems, PRIMUS gives you access to the resources of a world leading company for all your laundry solutions needs in the days, months and years ahead.

Alliance Laundry Systems delivers leading performance in commercial laundry through our family of brands, including Primus, specialized for tailor made in-house laundry solutions.

Laundry is our sole business: we design, produce and distribute globally, staying close to our customers with an extended network of Alliance sales offices, warehouses and more than 1200 expert distributors.

Alliance leads the world in commercial laundry sales, product range, global reach and R&D investment. We serve more than 140 countries with a team of more than 3,000+.



Check out the advantages you enjoy with us:

■ SUPERIOR TECHNOLOGY

The world needs faster, easier, better laundry. In recent years, we've invested over EUR 264 million in R&D to make it happen. Our global team of laundry scientists, engineers and designers are dedicated to purpose-driven laundry innovation.

■ BUSINESS AND FINANCIAL SERVICES

We aim to make laundry as cost-effective and rewarding as possible. In some regions, we support our customers with comprehensive financial services. In the past 20 years, we have helped laundry entrepreneurs grow with over EUR 1,7 billion in loans.

■ AWARD-WINNING CUSTOMER SUPPORT

Our outstanding customer service is dedicated to helping you develop the most efficient laundry operation possible and keeping it running at peak efficiency. Order Alliance Genuine Parts today and experience our exceptional service for yourself.

■ STRONGER NETWORK

You're never too far from better laundry, thanks to expert Alliance teams in 14 strategic locations worldwide and over 1,200 specialist commercial laundry distributors. No matter where in the world you are, big help with big laundry is always within reach.

■ COMPREHENSIVE TRAINING

Alliance Laundry Systems University offers training for everyone involved in the laundry process. Our laundry learning programs include operator training, service schools, maintenance seminars, business training and much more.

■ MEASURABLY BETTER

To get the excellence you deserve, you can rate our services at every interaction. If you're not happy, let us know and we'll make it good. Were we helpful? Share your opinion. Our team thrives on a positive vibe. Understanding your satisfaction helps us improve our performance.



WE TAILOR THE SOLUTION TO YOUR NEEDS FOR DRY OR WET MOPS

Our solution for dry or wet mops ensures a hygienic, flexible and efficient laundry process that preserves your mops for a longer lifespan.

Facility management requires expertise in any circumstance. We understand specific needs, that's why we focus on innovation to make your laundry process more efficient, more economical and more sustainable.

We offer complete, tailor-made mop cleaning solutions for your facility, fitting the needs of any segment (Hygienic cleaning, Professional cleaning or Heavy duty cleaning). Our machines are known for their robustness, user-friendliness and long life.

Project design, equipment, service and parts are all supported by an in-house financing.*

PRIMUS DELIVERS SUPERIOR VALUE OVER THE LONG TERM

Whether you work for the hygienic, professional or heavy-duty cleaning industry, our technology will make your facility management less of a hassle. Our expert team will help you design the perfect installation to ensure an extremely performing laundry process.

WE UNDERSTAND THE PRIORITIES OF YOUR INDUSTRY

PROFESSIONAL CLEANING



FABRICS LAST LONGER

Robust PRIMUS machines combine power with intelligence to significantly **extend the life of microfibers** in dry or wet mops and cleaning textiles. Taking better care of these pieces helps extend their useful life and reduces costs.

HYGIENIC CLEANING

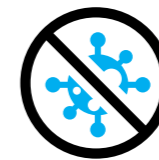

EASIER AND MORE HYGIENIC

PRIMUS barrier machines, separate soiled and clean items, giving your facility the flexibility of a tailor-made process **to adapt to any changes in regulations.**

HEAVY DUTY CLEANING

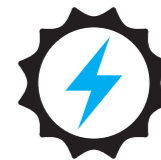

MORE EFFICIENT USE OF RESOURCES

PRIMUS delivers **optimum cleaning, lowest cost of ownership and most efficient water and energy consumption**, through engineering expertise in designing sustainable machines.

* Our financing solutions vary by country. Please contact your PRIMUS distributor for further details.

ENSURE A HYGIENIC, FLEXIBLE AND EFFICIENT LAUNDRY PROCESS THAT PRESERVES YOUR MOPS

1. PROCESS OPTIMIZATION FOR BETTER RESULTS



OPTIMIZE PROCESS TIME AND CLEANING EFFICIENCY

- Revolutionary Cascade drum design **accelerates dirt removal and protects mop fibers for a longer lifespan**. Washer drum design includes small bulges between the perforations for more mechanical action and better dirt removal. Despite strong extraction, **the linen does not stick to the drum .and reduces unloading time for operator.**



OPTIMIZE THE WASHING PROCESS RESULTING IN BETTER MOP CLEANING

- Optiload **calculates the accurate weight of the washload and automatically adapts the amount of water, energy and detergent for the cycle.**

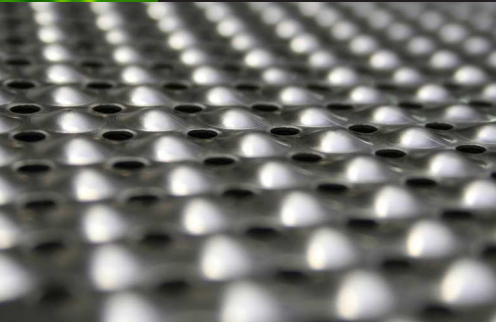

2. OPTIMIZED LABOUR FOR HIGHER EFFICIENCY



TAILOR-MADE PROGRAM LIBRARY HELPS WITH QUICK AND EASY SELECTION

- Innovative XControl programmer **brings unlimited programming possibilities**. New customer needs can be taken care of with tailored cycles easy and quickly to upload through a USB port.



READY-TO-USE LIQUID CHEMICALS

- With easySOAP, **staff no longer has to manually add laundry chemicals**. Plug-and-play access for up to eight dosing pumps ensures precise and accurate dosing of chemicals every cycle and eliminates waste.

3. GREAT TRACKING, ECO CONSCIOUS AND SAVINGS



MONITOR AND ANALYZE YOUR PROCESSES FOR BEST ROI

- Trace-Tech **records statistics for each cycle**, enabling tracking of data and helps to tailor programs to meet the needs of all dry or wet mops.



WASH SUSTAINABLE TECHNOLOGY

- We care about the environment, and we know that consumption costs are a key to your business. ECO3® is a sustainable technology, that **helps you reduce 15% water, 25% moisture and 20% of energy.***

* ECO3® technology is only available for FX line vs previous FS line.





SPECIAL CYCLES AND PROGRAMS INCLUDE:

- Thermal Disinfection

Cycles are suitable for dry or wet Mops, cotton or micro fiber. Wet mop process ensures perfect impregnation of the mop for immediate use for floor cleaning and disinfection. Tailored programs add the **disinfectant and remanent chemicals to the mops during last rinse.**

GET PRIMUS QUALITY ON DEDICATED DRY AND WET MOP-WASHING SOLUTION

PRIMUS has developed a new optional dirt collector, optimizing the draining process and reducing the maintenance for waste water drainage. Our expert laundry engineers worked with facilities managers to perfect algorithms that ensure optimal hygiene and cleanliness for microfiber cloths and cotton mops. Our new dry and wet mop-washing solutions have:

- Special programs to perfectly wash mops, wipers and more for soft mount machines with capacity up to 135 L
- Cycles developed for various mop head soil levels by experts in facility management
- Stainless steel dirt collector optional system for soft mount machines with capacity up to 280 L
- And, as always PRIMUS exceptional long lasting and wash quality



Our adaptable dirt collector collects all water drained during wash proces consumed by 135L washing machine to avoid draining issues.

*Available for FX line washers in the following capacities: 65 - 80 - 105 - 135 L

FIND THE PERFECT INSTALLATION FOR YOUR FACILITY



TESTED AND CERTIFIED BY EXPERTS FOR DISINFECTION AT 40°C*

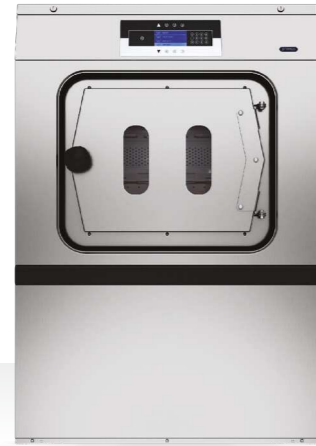

FXB Line
From 18 kg to 28 kg



FX line
From 6.5 Kg to 28 kg



SP10 compact washer 10 Kg



T line
From 9 kg to 35 kg

HYGIENIC BARRIER WASHER	SOFT MOUNTED	SEMI-COMMERCIAL	COMMERCIAL DRYER
Recommended for Hygienic Cleaning facility	Recommended for Heavy Duty Cleaning facility	Recommended for Professional Cleaning facility	Recommended for all types of washers.
<p>FEATURES</p> <ul style="list-style-type: none"> Freestanding, high spin fitting any flooring and building Xcontrol plus, easy intuitive to use microprocessor for tailored cycles Stainless steel drum and tub for long life PowerWash - perforated lifting ribs: better washing results, lower water consumption SuperEco washing programs - significantly reduce water and electricity consumption Large door opening and automatic positioning for quick loading and unloading High capacity water inlets for quick feeding and fast cycle Large drain valve for easy flush of soiled water (Ø 76 mm) and low maintenance Compatible with tracking software Tracetech <p>TECHNOLOGIES</p> <ul style="list-style-type: none"> Optiload Ultra Balance® Easy-Soap ECO3® Soap Hopper 	<p>FEATURES</p> <ul style="list-style-type: none"> Freestanding, high spin fitting any flooring and building Xcontrol plus, easy intuitive to use microprocessor for tailored cycles Stainless steel drum and tub for long life PowerWash - perforated lifting ribs: better washing results, lower water consumption SuperEco washing programs - significantly reduce water and electricity consumption Large door opening for quick loading and unloading Large drain valve for easy flush of soiled water (Ø 76 mm) and low maintenance Easy access to all vital parts from the front for fast maintenance Compatible with tracking software Tracetech <p>TECHNOLOGIES</p> <ul style="list-style-type: none"> Cascade drum Optiload Ultra Balance® Easy-Soap ECO3® Special mop cycles + optional dirt collector for capacities 65 - 80 - 105 - 135 L 	<p>FEATURES</p> <ul style="list-style-type: none"> Freestanding, high spin fitting any flooring and building XQcontrol, easy intuitive to use microprocessor for tailored cycles Painted cabinet Stainless steel drum and tub for long life Large door opens 180° for quick loading and unloading 4 liquid ports for secured dosing Standard with drain pump, drain valve optionally available Electrical heating or boiler-fed <p>TECHNOLOGIES</p> <ul style="list-style-type: none"> Special mop cycles+ optional dirt collector (this is also available in the accessories list) 	<p>FEATURES</p> <ul style="list-style-type: none"> Easy-to-use microprocessor Stainless steel drum for longer Mops life time Large door opening for easy and fast loading and unloading Combination of radial and axial airflow RADAX® maximizing drying speed and efficiency at low energy consumption Self cleaning lint screen reducing daily cleaning and keep drying efficiency Full Control programmer (FCT) for tailor-made programming - optional Reversing drum for faster drying - optional Residual moisture control Sensodry® for extra care of delicate fibers and longer Mop life - optional Heat Pump version available for lower energy consumption - optional <p>TECHNOLOGIES</p> <ul style="list-style-type: none"> RADAX® air flow Sensor Dry®
RANGE AVAILABLE: FXB180, FXB240, FXB280**	RANGE AVAILABLE: FX65, FX80, FX105, FX135, FX180, FX240, FX280**	RANGE AVAILABLE: SC65, SP10, SPS10	RANGE AVAILABLE: T9, T11, T13, T24**

*99,9999 % reduction of Escherichia coli K12 NCTC 10538, Staphylococcus aureus ATCC 6538, Salmonella enterica ATCC 13076, Candida albicans ATCC 10231, Aspergillus brasiliensis ATCC 16404 in the mop washing program „Mop washing program for main wash temperature 40° C“ with „Eltra 40 extra“ laundry detergent and a load size of 7.5 kg - investigation MB 1880/19 dated April 16, 2020 conducted by wfk-Institut für Angewandte Forschung GmbH commissioned by Alliance Laundry CE s.r.o..

**Larger capacity on demand

OUR REFERENCES PROVE OUR EFFICIENCY

References of facilities from the industry of:
 Professional Cleaning
 Hygiene Cleaning

3 x FXB240 =
 Facility management Installation at Magris
 - Le Molinette Rome, Italy

“Our expert team designed here a 3 x 28 kg compact machines installation, to offer high process flexibility under the highest hygiene standards. Now, the customers have clean pre-impregnated mops every 30min.”

Vittorio Maglione
 ALS Country Manager Italy



Each installation has its own needs and requirements. At Primus we understand this better than anyone.

Discover 3 examples of fully tailored solutions for facility management.

3 x SP10=
 Installation at AFGP Piamarta, Milan, Italy

“In this case, our client has a contract for services within a multi-purpose center with 3 main structures; the goal was to manage the mop stock of each structure separately. Thanks to the installation of 3 x SP10 washing machines, it currently manages without problems the 3 different stocks of mops with different types of washing, sanitizing and pre-impregnation with a net saving of time and money.”

Silvi Pulizie
 AFGP Piamarta

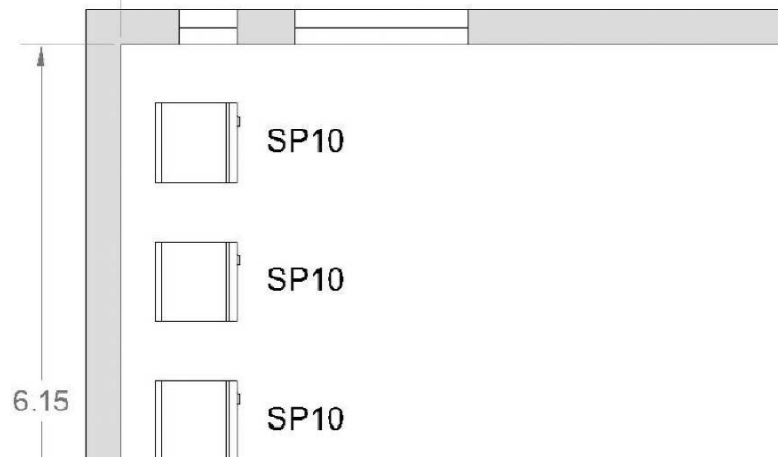
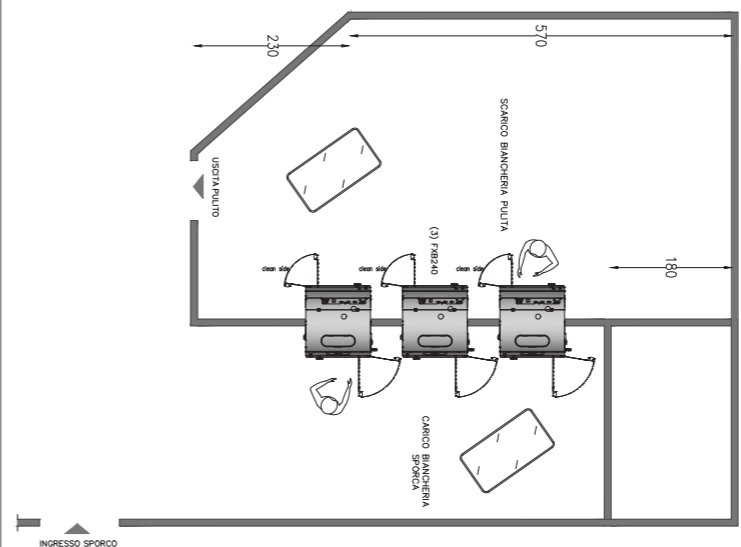

LET'S DISCUSS TOGETHER HOW TO SET UP THE PERFECT FORMULA FOR YOUR NEEDS.

CONTACT US TODAY.



CZECH REPUBLIC

Alliance Laundry CE
Místecká 1116
Příbor, 742 58, Czech Republic
Tel: +420 556 768 800
Fax: +420 556 768 882

